

JOINT DOUBLE et JOINT SIMPLE

Rubrique 18 - Page 1 à 9

JOINT DOUBLE et JOINT SIMPLE

FIG A :

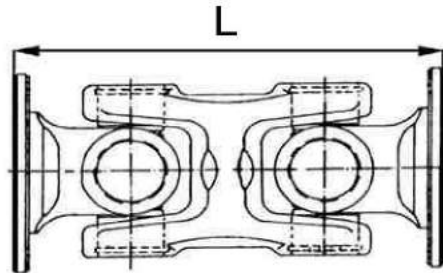

FIG B :

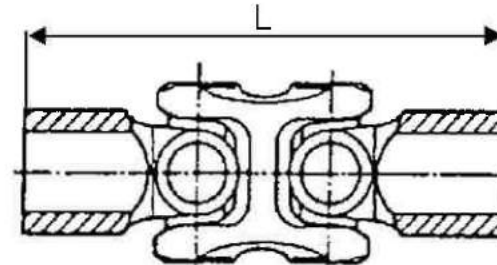

FIG 8 : SAE 4 TROUS

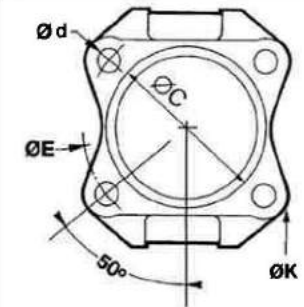

FIG C :

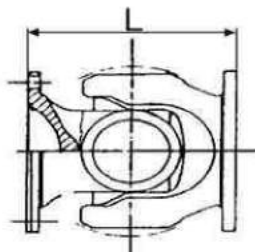

FIG D :

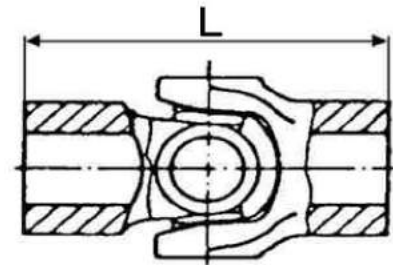

FIG 7 : SAE 8 TOUS

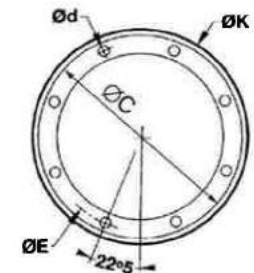

FIG 1 : DIN 4 TROUS

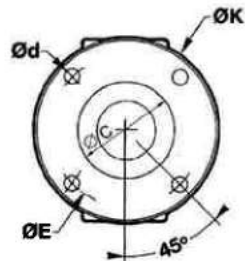

FIG 2 : DIN 6 TROUS

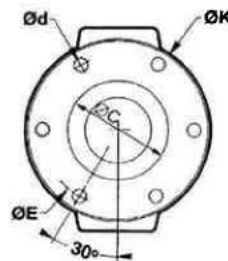

FIG 3 : DIN 8 TROUS

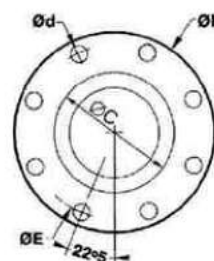

FIG 4 : DIN 10 TROUS

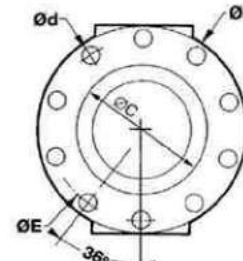

FIG 5 : DENT. 4 TROUS

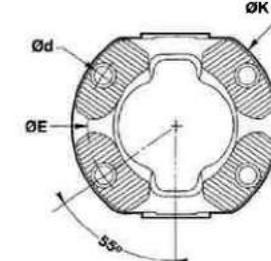
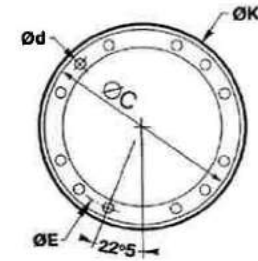

FIG 6 : SAE 12 TROUS



REFERENCE	SERIE	BLOC	L	TYPE	Ø C	Ø K	Nbr	Ø d	Angle V max	FIG.	REMARQUES	ORIGINE
0 - 105 - 401	105	17 x 41	60	DIN	35	65	4	6	25°	C1		ELBE
0 - 105 - 300	105	17 x 41	110	DIN	30	58	4	5	30°	A1		ELBE
0 - 105 - 301	105	17 x 41	110	DIN	35	65	4	6	25°	A1		ELBE
0 - 105 - 302	105	17 x 41	150						30°	B	MOYEU ALESAGE DE 20 CLAVETTE DE 6	ELBE
0 105 203 800	105	17 x 41	350						30°	B	AL. 22 + 2 x CLA 8 / Z18 Ø 25-22,5	ELBE
100001678GE		19 x 47,2								D	Joint simple de direction Cannelures env. Ø 24 serrage pince	
0-106-401-001	106	19 x 48	64	DIN	42	75	6	6	20°	C2		ELBE
0 - 106 - 300	106	19 x 48	120	DIN	35	65	4	6	30°	A1	0-106-300-5003 = blocs G/cous.	ELBE
0 - 106 - 301	106	19 x 48	120	DIN	42	75	6	6	20°	A2		ELBE
0-106-300-5005	106	19 x 48	140	DIN	35	65	4	6	30°	A1		ELBE
0 - 106 - 302	106	19 x 48	176						30°	B	MOYEU ALESAGE DE 25 CLAVETTE DE 8	ELBE
0 106 202 011	106	19 x 48	270						30°	B	Cannelures Ø 25-22 Z14	ELBE
1106281001	106	19 x 48	56								uniquement H central	ELBE
7714220201004			72	SAE	45	84	4	8		C	Bride 38x52 - YALE - HYSTER	
9705200501014		20,5 x 56,6	178	SAE	34		4	8		A-B	1 x MACH. EXT. 13 CAN. 19x21 / MITSUBISHI	EDS
2080310057		22 x 37,8IC	156			98	4	9		A-B	Bride sans centrage 56x56 - Mac. Al. 22x19 13 cannelures	
9705220501001		22 x 36IC	160			98	4	9		A-B	Bride sans centrage 57x57 - Mac. Al. 18 - 10 cannelures	
9705200501014			190	SAE	34	72	4	8		A-B	Bride 25x50 - Mac. Al. 22/19 - 13 cannelures	
0 - 107 - 300	107	22 x 58	140	DIN	42	75	6	6	30°	A2		ELBE
0 - 107 - 301	107	22 x 58	140	DIN	47	90	4	8	18°	A1	0-107-301-861 = blocs G/cous.	ELBE
0-107-300-5000	107	22 x 58	150	DIN	42	75	6	6	30°	A2		ELBE

JOINT DOUBLE et JOINT SIMPLE

FIG A :

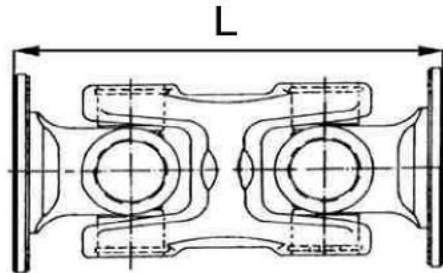

FIG B :

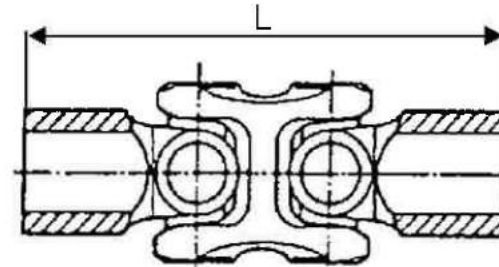

FIG 8 : SAE 4 TROUS

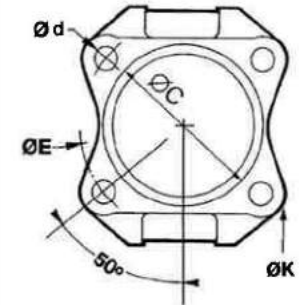

FIG C :

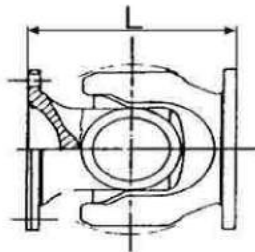

FIG D :

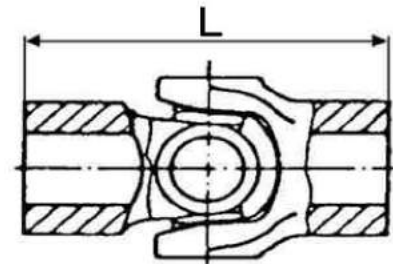

FIG 7 : SAE 8 TOUS

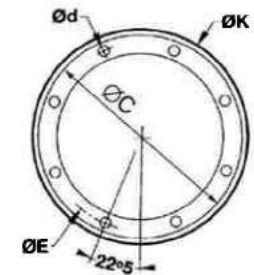

FIG 1 : DIN 4 TROUS

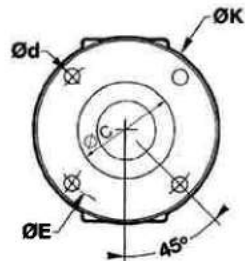

FIG 2 : DIN 6 TROUS

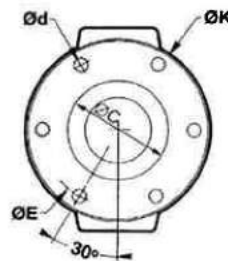

FIG 3 : DIN 8 TROUS

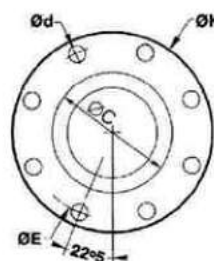

FIG 4 : DIN 10 TROUS

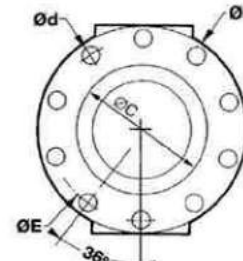

FIG 5 : DENT. 4 TROUS

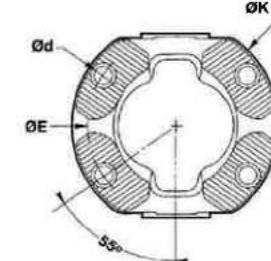
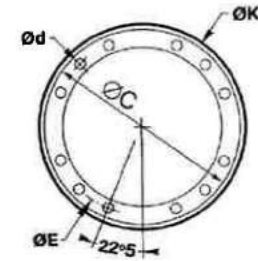

FIG 6 : SAE 12 TROUS



REFERENCE	SERIE	BLOC	L	TYPE	Ø C	Ø K	Nbr	Ø d	Angle V max	FIG.	REMARQUES	ORIGINE
0 - 107 - 302	107	22 x 58	228						30°	B	MOYEU ALESAGE DE 30 CLAVETTE DE 8	ELBE
0-107-202-012	107	22 x 58	270							B	MOYEU ALESAGE 14 CAN. 22x25	ELBE
01073090002	107	22 x 58	164							A/B	DIN75 / Al 25H7 + RC + 2 vis serrage	ELBE
47330905	473-30	22 x 59	150	DIN	42	75	6	6		A2		EDS
1448001X2	1110	23,8 x 61,2	120	SAE	57,1	90	4	8,2		A8	BRIDE RONDE	
0012099	287-00	26 x 69,8	60								Lg axe à axe - Livré sans blocs et brides	SPICER GWB
314034010000	287-00	26 x 69,8	104	DIN	47	90	4	8	35°	C1	DIN 90 - 4 x 8	IFA
9287000500010	287-00	26 x 69,8	135	DIN	47	90	4	8		A1	DIN 90 - 4 x 8	EDS
761103401000	287-00	26 x 69,8	139	DIN	47	90	4	8	15°	A1	DIN 90 - 4 x 8	
70210006/0025X	1210	27 x 61,9	181	SAE	57,1	88	4	8,1	15°	8	SAE 1210 / END-YOK 13 CAN. Ø 19/22 - SANDERSON	DANA SPICER
176795	1210	27 x 61,9	235	SAE	57,1	88	4	8,1	15°	8	SAE 1210 / END-YOK 13 CAN. Ø 19/22 -MANITOU	DANA SPICER
03-494	1210	27 x 61,9	END-YOK 13 CAN. Ø 19/22									
3099070	1300	27 x 74,6	70							A	Livré sans bride et sans blocs - LG AXE A AXE	
2200159000064	1310	27 x 81,7	64							A	Livré sans bride et sans blocs - LG AXE A AXE	
226 497	1310	27 x 81,7	68						26°	A	Livré sans bride et sans blocs - LG AXE A AXE	
21860951109	1310	27 x 81,7	75								Bol sans bloc	
226 477	1310	27 x 81,7	84						26°	A	Livré sans bride et sans blocs - LG AXE A AXE	
H1310L101	1310	27 x 81,7	101							A	Livré sans bride et sans blocs - LG AXE A AXE	
44310003X	1310	27 x 81,7	133	SAE	60,3	98	4	10		A8	Lg axe = 63 mm (existe lg 68 et 84)	DANA SPICER
9127030128	1310	27 x 81,7	220							B	130 axe-axe - Ouvert / Z 10 Ø 28,5-26,1 H87	DANA SPICER
0 - 109 - 300	109	28,5 x 70,9	152	DIN	47	90	4	8	20°	A1		ELBE

JOINT DOUBLE et JOINT SIMPLE

FIG A :

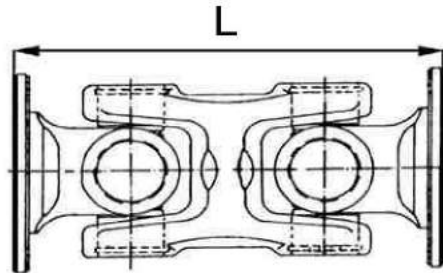

FIG B :

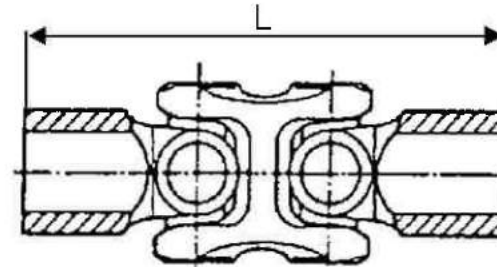

FIG 8 : SAE 4 TROUS

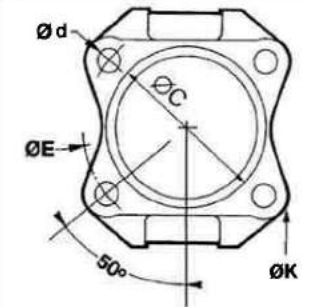

FIG C :

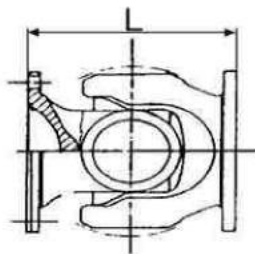

FIG D :

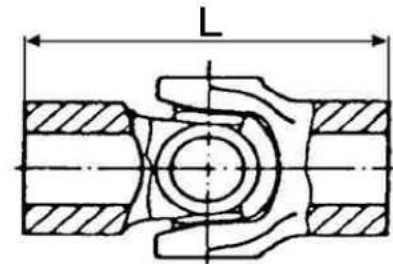

FIG 7 : SAE 8 TOUS

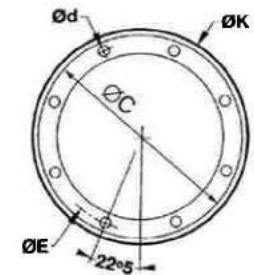

FIG 1 : DIN 4 TROUS

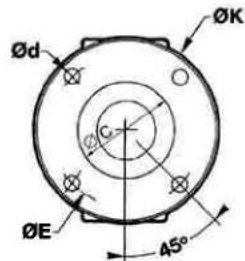

FIG 2 : DIN 6 TROUS

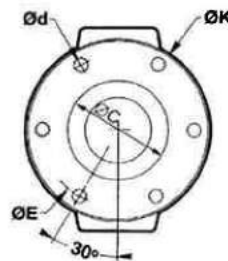

FIG 3 : DIN 8 TROUS

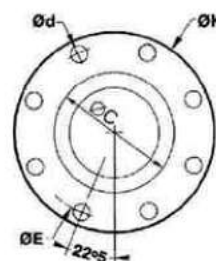

FIG 4 : DIN 10 TROUS

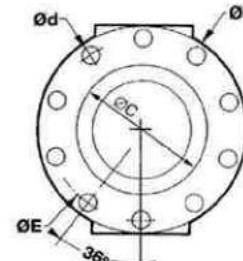

FIG 5 : DENT. 4 TROUS

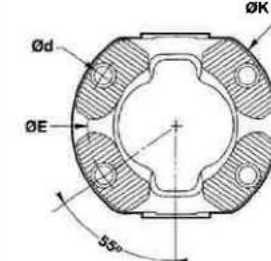
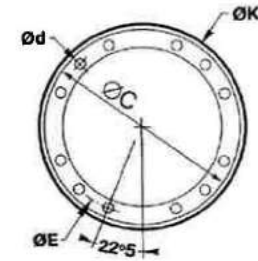

FIG 6 : SAE 12 TROUS



REFERENCE	SERIE	BLOC	L	TYPE	Ø C	Ø K	Nbr	Ø d	Angle V max	FIG.	REMARQUES	ORIGINE
0 - 109 - 301	109	28,5 x 70,9	152	DIN	57	100	6	8	18°	A2		ELBE
0-109-300 5001	109	28,5 x 70,9	162	DIN	47	90	4	8	20°	A1	Bride H=42 et H=52	ELBE
0-109-309-0213	109	28,5 x 70,9	184	DIN	50	79	4	8	20°	A	Bride à deux tenons de 8 type UNIMOG	ELBE
DJFU	109	28,5 x 70,9	186	DIN	50	79	4	8		A	Bride à deux tenons de 8 type UNIMOG	
0 - 109 - 302	109	28,5 x 70,9	228						20°	A	MOYEU ALESAGE DE 35 CLAVETTE DE 10	ELBE
9880020514638	2C	33,3 x 59,7	75								Lg du H : 20 mm Bloc patins LWD	EDS
0-110-405	110	30 x 83	116	DIN	57	100	6	8	35°	C2		ELBE
0-110-300-001	110	30 x 83	160	DIN	57	100	6	8	20°	A2		ELBE
0 - 110 - 301	110	30 x 83	160	DIN	75	120	8	8	18°	A3		ELBE
0 110 300 5002	110	30 x 83	172	DIN	57	100	6	8	20°	A2		ELBE
0 - 110 - 302	110	30 x 83	248						20°	B	MOYEU ALESAGE DE 40 CLAVETTE DE 12	ELBE
S230H	1410	30,1 x 106,3	85								SANS BLOC ET BRIDE	DANA SPICER
3 26 667	1480	34,9 x 106,3	85							A	SANS BLOC ET BRIDE	DANA SPICER
3 26 677	1480	34,9 x 106,3	107,7							A	SANS BLOC ET BRIDE	DANA SPICER
4 26 437	1550	34,9 x 126,1	100						24°	A	SANS BLOC ET BRIDE	DANA SPICER
4 26 677	1550	34,9 x 126,1	107,7							A	SANS BLOC ET BRIDE	DANA SPICER
1 112 281 201	112	35 x 97	80						20°	A	SANS BLOC ET BRIDE	ELBE
0 - 112 - 401	112	35 x 97	120	DIN	90	150	8	10	18°	A3		ELBE
0 - 112 - 300	112	35 x 97	200	DIN	75	120	8	8	20°	A3		ELBE
0 - 112 - 301	112	35 x 97	200	DIN	90	150	8	10	18°	A3		ELBE
0 - 112 - 302	112	35 x 97	390						20°	B	MOYEU ALESAGE DE 45 CLAVETTE DE 14	ELBE

JOINT DOUBLE et JOINT SIMPLE

FIG A :

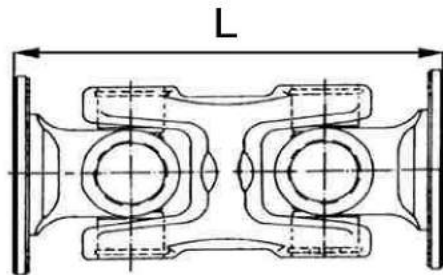

FIG B :

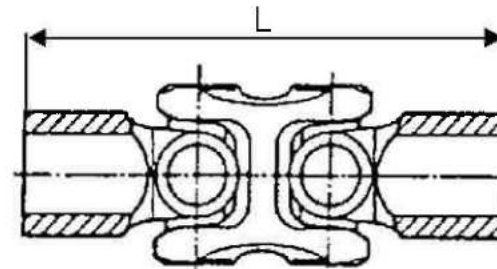

FIG 8 : SAE 4 TROUS

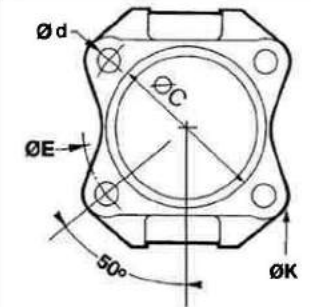

FIG C :

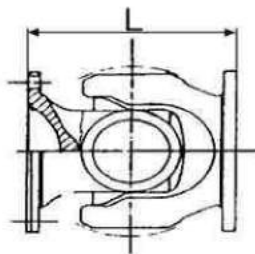

FIG D :

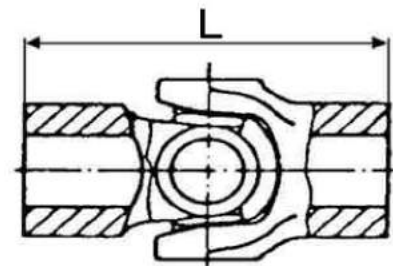

FIG 7 : SAE 8 TOUS

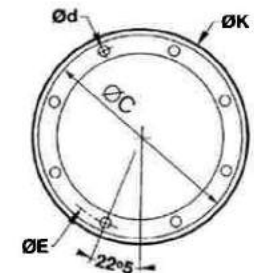

FIG 1 : DIN 4 TROUS

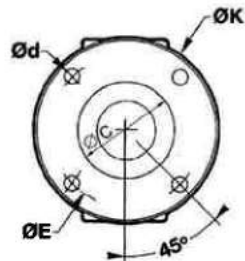

FIG 2 : DIN 6 TROUS

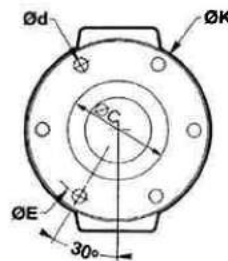

FIG 3 : DIN 8 TROUS

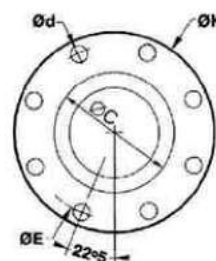

FIG 4 : DIN 10 TROUS

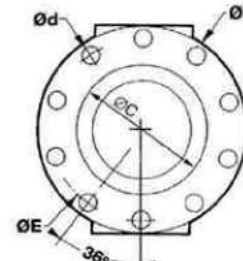

FIG 5 : DENT. 4 TROUS

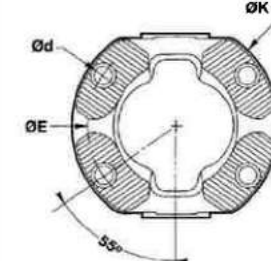
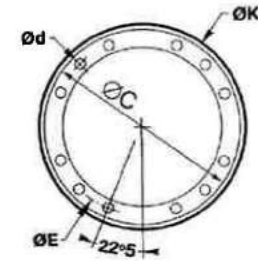

FIG 6 : SAE 12 TROUS



REFERENCE	SERIE	BLOC	L	TYPE	Ø C	Ø K	Nbr	Ø d	Angle V max	FIG.	REMARQUES	ORIGINE
0 - 113 - 300	113	38 x 106	200	DIN	75	120	8	10	12°	A3		ELBE
0 - 113 - 301	113	38 x 106	200	DIN	90	150	8	10	12°	A3		ELBE
0-113-300-5001	113	38 x 106	212	DIN	75	120	8	10		A3		ELBE
0 - 113 - 302	113	38 x 106	430						12°	B	MOYEU ALESAGE DE 55 CLAVETTE DE 16	ELBE
0 - 148 - 300	148	42 x 117,5	235	DIN	90	150	8	10	20°	A3	DISPONIBLE AVEC BRIDE DIN 120	ELBE
0 - 148 - 301	148	42 x 117,5	235	DIN	110	180	8	12	20°	A3	DISPONIBLE AVEC BRIDE DIN 120	ELBE
0 - 148 - 302	148	42 x 117,5	497						20°	B	MOYEU ALESAGE DE 60 CLAVETTE DE 18	ELBE
2587209500100	587-20	48 x 116,5	115							A	SANS BLOC ET BRIDE	
6 26 597	1710	49,2 x 154,7	155							A	SANS BLOC ET BRIDE	DANA SPICER
0 - 117 - 300	117	53 x 135	296	DIN	90	150	12	12	15°	A	BRIDE NON REPRESENTEE	ELBE
0 - 117 - 301	117	53 x 135	296	DIN	95	165	8	16	15°	A3		ELBE
0 - 117 - 302	117	53 x 135	296	DIN	110	180	8	16	15°	A3		ELBE
4816-1096-AU8	587-42	57 x 152	299	DIN	225	140	8	16	22°	A3		KEMPF
360543011	5C		101								5C Méchanics blocs HWD	
2880069000028	6C		28,5								6C Méchanics - H de liaison sans les blocs	
H9CLG76	9C		76								9C Méchanics - H de liaison sans les blocs	

