

TRANSMISSION INDUSTRIELLE

LONG COULISSEMENT

Rubrique 17 - Page 1 à 5

TRANSMISSION INDUSTRIELLE LONG COULISSEMENT

FIG A :

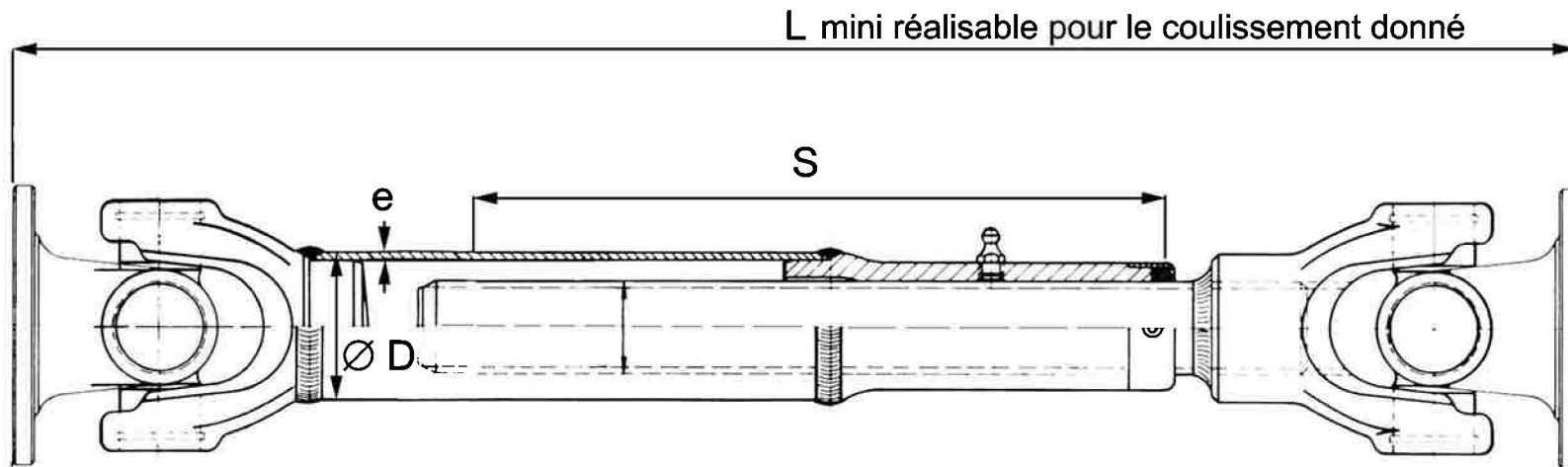

FIG 8 : SAE 4 TROUS

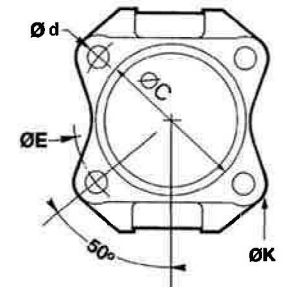

FIG 7 : SAE 8 TROUS

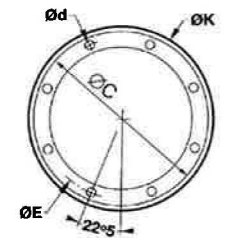

FIG 1 : DIN 4 TROUS

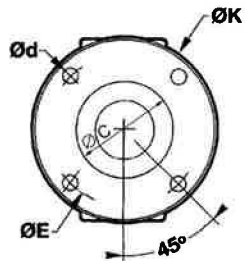

FIG 2 : DIN 6 TROUS

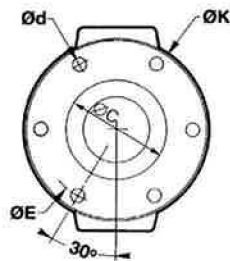

FIG 3 : DIN 8 TROUS

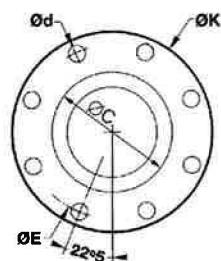

FIG 4 : DIN 10 TROUS

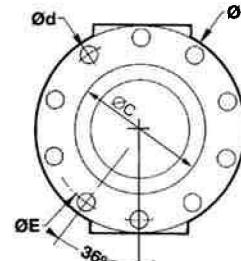

FIG 5 : DENT. 4 TROUS

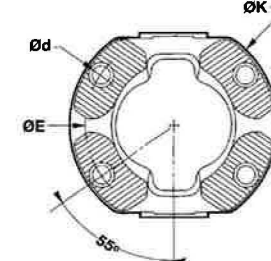
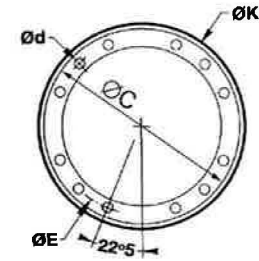

FIG 6 : SAE 12 TROUS



REFERENCE	BLOC	Coulis- sement	Longueur MINI	BRIDE	Joint Coulissant	Joint Fixe	Angle max	Fig	REMARQUES	ORIGINE
0 107 110 5030	22 x 58	125	400	DIN 75 / 6 / 6			20°	A2		ELBE
0 107 110 5002	22 x 58	150	440	DIN 75 / 6 / 6			20°	A2		ELBE
		280	395		0107096006				Ens. Coul. LF 395 coul 280	
020900050660	26 x 64,3	80	370	DIN 90 / 4 / 8			35°	A1		WET
03090050X200	26 x 64,3	200	530	DIN 90 / 4 / 8			35°	A1		WET
EC1310BC30	27 x 81,7	225	Ensemble coulissant uniquement						BC lg 300 - Tube 50,8 x 2,4	
0 109 110 295	28,5 x 70,9	400	690	DIN 90 / 4 / 8			20°	A1		ELBE
0 109 115 5014	28,5 x 70,9	120		DIN 90 / 4 / 8			35°	A1	Ens. Coul. 0.110.099.005	ELBE
EC28710LA330	30 x 81,8	330	Ensemble coulissant uniquement						BC lg 380 - Tube 50 x 3	
0 110 115 058	30 x 83	200	530	DIN 100 / 6 / 8			35°	A2	Lg mini=520 H=58 BM évidée	ELBE
0 110 115 062	30 x 83	250	600	DIN 100 / 6 / 8			35°	A2	Lg mini=600 H=58 BM évidée	ELBE
0 110 099 006	30 x 83	250	Ensemble coulissant uniquement				35°		Tube 50 x 3	ELBE
0 110 110 5024	30 x 83	300	650	DIN 100 / 6 / 8			20°	A2	Lg mini=650 H=46 BM évidée	ELBE
0 110 115 5016	30 x 83	300	680	DIN 100 / 6 / 8			35°	A2	Lg mini=680 H=58 BM évidée	ELBE
0 110 115 5009	30 x 83	400	810	DIN 100 / 6 / 8			35°	A2		ELBE
0 110 110 5025	30 x 83	550	910	DIN 100 / 6 / 8			20°	A2		ELBE
0 110 110 5035	30 x 83	700		DIN 100 / 6 / 8			20°	A2		ELBE
EC1410BC50	30,1x106,3	425	Ensemble coulissant uniquement						BC lg 500 Em de 84 à 60	
0 112 110 5008	35 x 97	300	685	DIN 120 / 8 / 8			20°	A3		ELBE
0 112 115 5011	35 x 97	300		DIN 120 / 8 / 8			35°	A3		ELBE
0 112 115 5003	35 x 97	500		DIN 120 / 8 / 8			20°	A3		ELBE
	38 x 106	500	960	DIN 120 / 8 / 10	113 070 012	113 050 001	20°	A3		ELBE

TRANSMISSION INDUSTRIELLE LONG COULISSEMENT

FIG A :

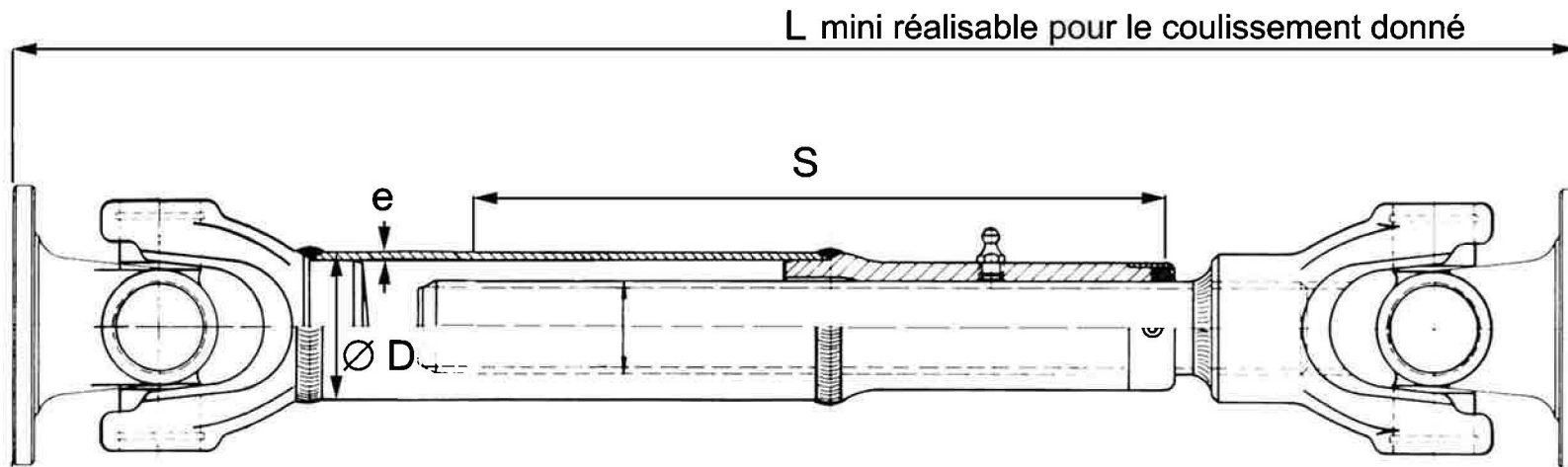

FIG 8 : SAE 4 TROUS

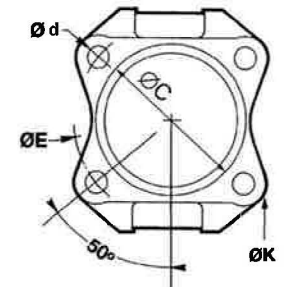

FIG 7 : SAE 8 TROUS

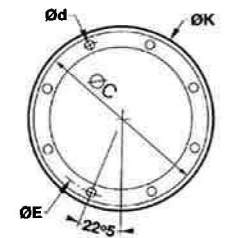

FIG 1 : DIN 4 TROUS

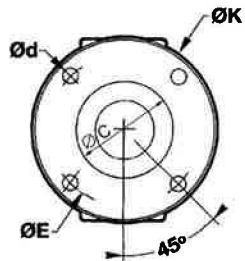

FIG 2 : DIN 6 TROUS

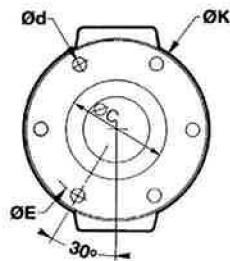

FIG 3 : DIN 8 TROUS

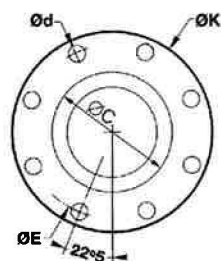

FIG 4 : DIN 10 TROUS

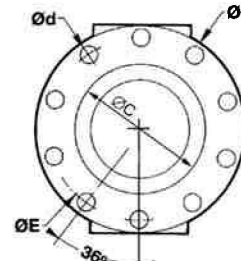

FIG 5 : DENT. 4 TROUS

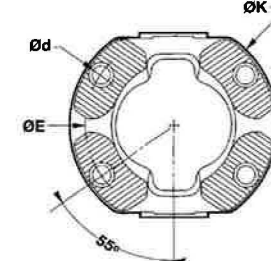
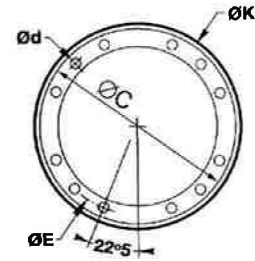

FIG 6 : SAE 12 TROUS



REFERENCE	BLOC	Coulis- sement	Longueur MINI	BRIDE	Joint Coulissant	Joint Fixe	Angle max	Fig	REMARQUES	ORIGINE
		200	284		0112099204				Ens. Coul. LF 284 coul 200	
0 158 115 5019	48 x 126	830	200	DIN 150 / 8 / 12			35°	A3		ELBE

